

Enclosures

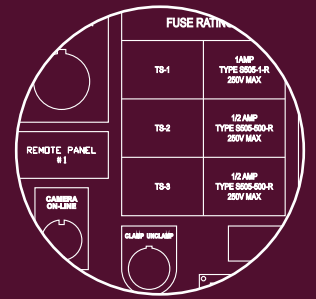

Legend Plates

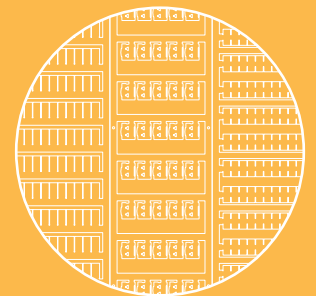

Industrial Markers

**Comprehensive product alterations
including enclosures, legend plates
and industrial markers**

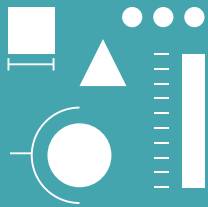

Precise & error-free

Eliminate the hassle of painstakingly laying out, drilling, and cutting out your design.

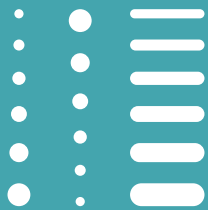

Drill. Tap. Mill.

We can mill any shape needed to accommodate your enclosure-mounted devices.



Modify almost any material

Plastic, steel, stainless, or fiberglass

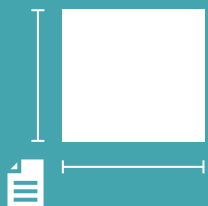

Order easily by supplying existing design files.

All files are kept for easy repeatability.



GET MODIFIED ENCLOSURES IN THREE DAYS OR LESS

PUT AN END TO THE TIME-CONSUMING AND COSTLY METHODS OF PERFORMING ENCLOSURE MODIFICATIONS

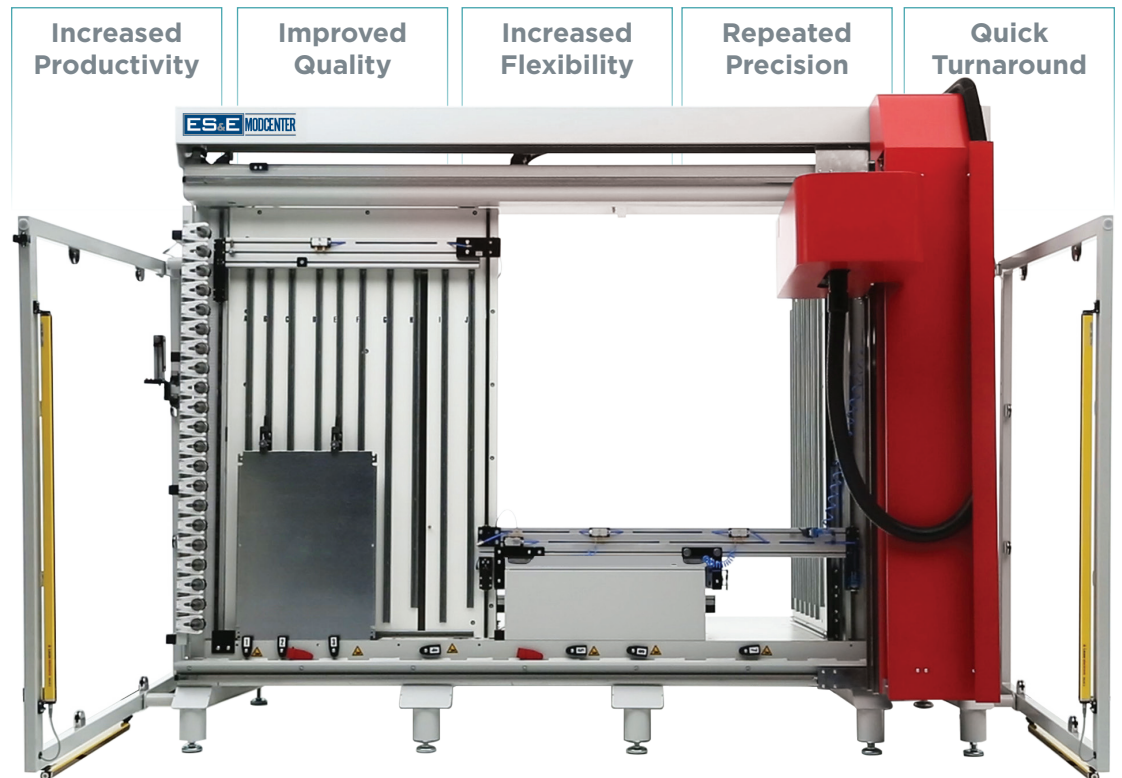

With ES&E's large inventory of standard enclosures and panels, combined with the ES&E Modcenter machine, you can stop wasting time performing manual holes and cutouts and get more projects done.

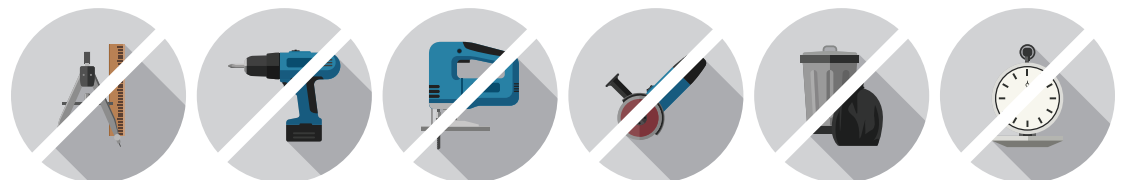

NO MEASURING

NO DRILLING

NO CUTTING

NO DEBURRING

NO REJECTS

NO WAITING

Multiple Manufacturer Support

We can modify a variety of manufacturers' enclosures including but not limited to: Appleton, Austin, B-Line, Crouse-Hinds, Hammond, Hoffman, Saginaw, Rittal, and Wiegmann.

LEGEND PLATES

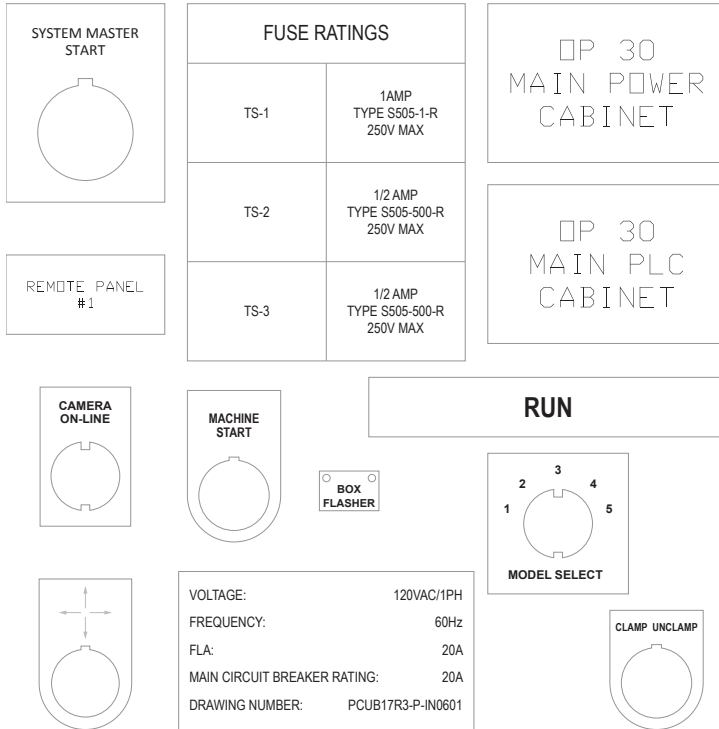

Whether you need 5 or 5000, ES&E can provide custom, laser-engraved plates including:

- » Pushbutton legend plates
- » Panel tags
- » Component I.D. tags
- » Valve tags and markers
- » MCC nameplates
- » Pipe markers
- » Safety and instructional plates

- Quick turnaround
- Allen-Bradley 800F - 1, 2, and 3 lines
- Allen-Bradley 800F - standard, auto, and jumbo
- Custom sizes up to 12" x 24"
- Adhesive backing available
- Multiple colors available
- Quantity pricing available

INDUSTRIAL MARKERS

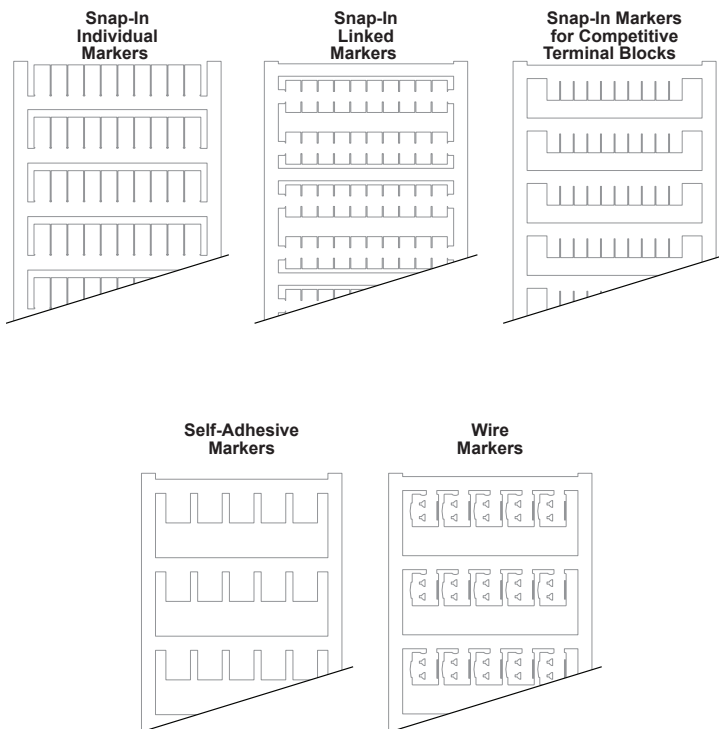

Let ES&E create your marker cards to use on a variety of industrial components including:

- » IEC Terminal Blocks
- » Fuse Holder
- » IEC Contactors
- » NEMA Terminal Blocks
- » General Purpose and Industrial Relays
- » Motor Protectors
- » PanelConnect™
- » Electric Overloads
- » IEC Push Buttons
- » Wire #20 - #12 AWG

- Quick turnaround
- Custom markers with logos or symbols
- Print from library or use your own image
- Color printing on white marker cards
- Inkjet printing using water-based inks bonded to marker cards with heat
- Free software to design your own labels

Enclosure FAQs

What do you need for a quote?

CAD (.dxf/.dwg) drawing of dimensions and layout is preferred. If not, please provide:

- Part number or dimensions of enclosure/panel being modified
- Dimensions and location of cutouts or part numbers if cutout dimensions are unknown

What is the lead time?

Once the item is at ES&E, it can be delivered within 2-3 days. Subject to change based on quantity.

Up to what size of enclosure can you modify?

Enclosures up to 93" and back panels up to 92" by 94".

What materials can you modify?

Mild steel, stainless steel, polycarbonate, aluminum

Does it have to be Hoffman?

No. Our machine can modify any enclosure/panel as long as it is one of the materials stated above.

Legend Plate FAQs

What do you need for a quote?

- Text, color and size if standard push button or rectangular/square tag.
- Drawing if unique shape or other specification.

What is the lead time?

1-2 days. Next day delivery available based on quantity and if PO is placed in the morning.

What sizes can you make?

We can accommodate any shape up to 12" x 24".

What materials can you engrave/cut?

Plastic can be engraved and cut. Metals such as stainless steel can be engraved but not cut – limited to standard sizes.

Industrial Marker FAQs

How do I get started?

Download and install the ClearTools software from our website. You can then create your custom marker card using the printer software and save the file to your computer. E-mail the custom marker file to: tbprinter@ese-co.com.

What else do I need to include?

- Quantity (the number of copies needed)

- Company information (with a contact name and phone number)
- ClearTools data file (attached to the e-mail)
- If you are printing a graphic and/or logo, please be sure to include a high-quality version along with your ClearTools data file.

What is the lead time?

1-2 days

Electric Supply & Equipment Company

electrical devices, automation solutions, and value-added services since 1935
800.632.0268 • sales@ese-co.com • www.ese-co.com • after hours support: 800.367.3862

Triad Area

1812 E. Wendover Ave
Greensboro, NC 27405
P: 336.272.4123 • F: 336.274.4632

Triangle Area

1000 Classic Road
Apex, NC 27539
P: 919.363.4800 • F: 919.363.4818

Eastern N.C.

147 Red Iron Road
Rocky Mount, NC 27804
P: 252.446.0315 • F: 252.446.4607